

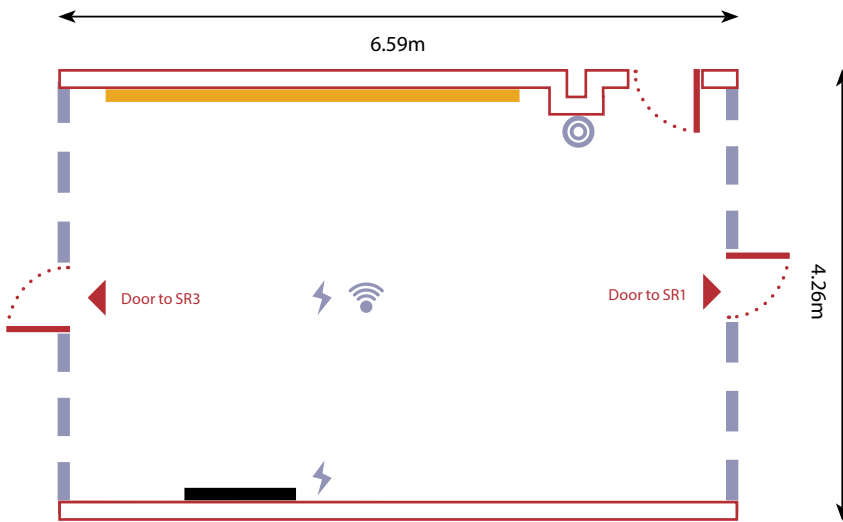

WIMPOLE<sub>St</sub>

## ROOM GUIDE: Seminar Room 2



### CAPACITIES

- Theatre:** 20
- Boardroom:** 14
- Reception:** 20
- Standing Buffet:** 15

### DIMENSIONS

- Length:** 6.59m
- Width:** 4.26m
- Height:** (highest point): 2.60m

### KEY ITEMS INCLUDED IN ROOM HIRE

- 52" HD LCD monitor
- Internet access with Wi-Fi

- ⊙ Climate Control
- ⚡ Power Plug
- 📶 Wired Internet Access

- LCD Screen
- Dry Wipe Board
- - - Moveable Wall

# FLOOR GUIDE

## 3rd FLOOR

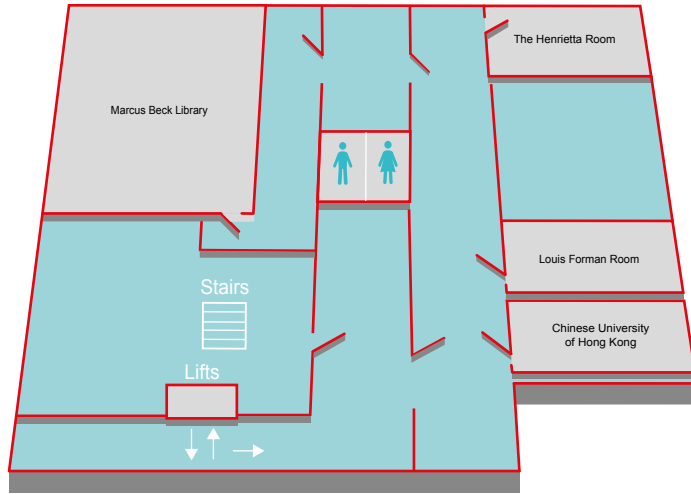

## GROUND FLOOR



## LOWER GROUND FLOOR

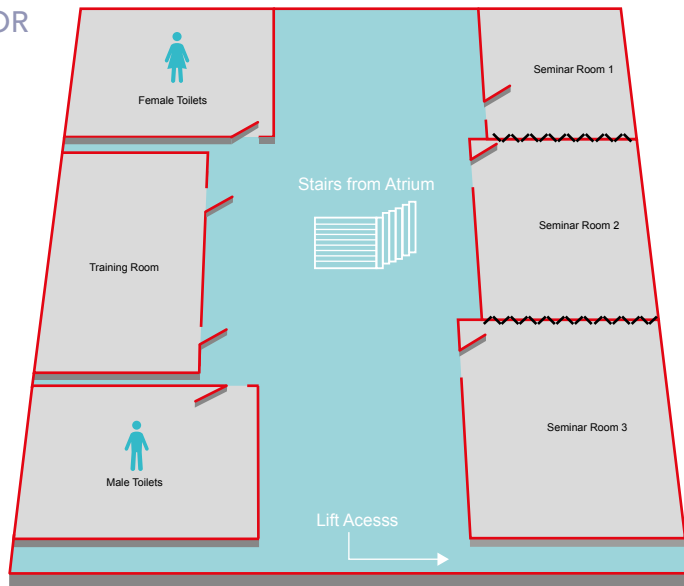

# GROUND FLOOR

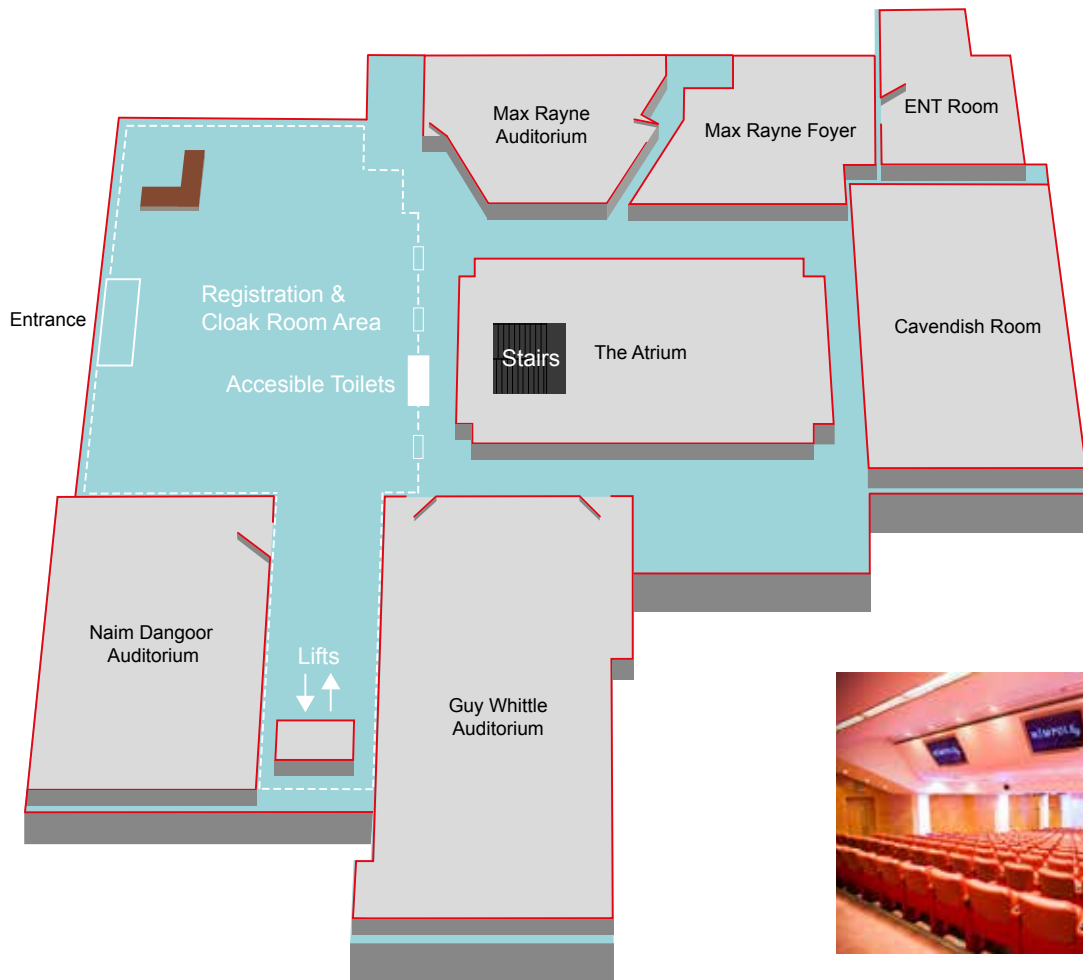

Guy Whittle Auditorium



Naim Dangoor Auditorium



ENT Room



The Atrium



Max Rayne Auditorium



Max Rayne Foyer



Cavendish Room

# LOWER GROUND FLOOR

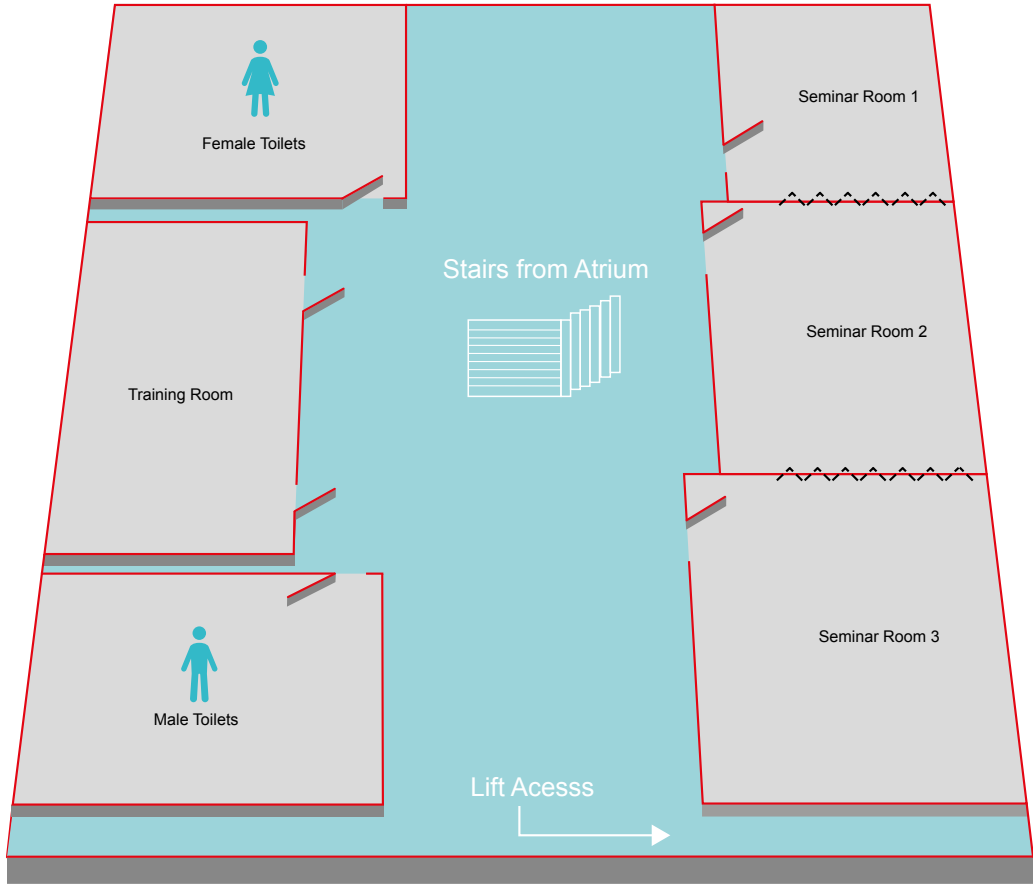

Seminar Room 1



Seminar Rooms Entire Suite



Training Room



Seminar Room 3

# 3rd FLOOR

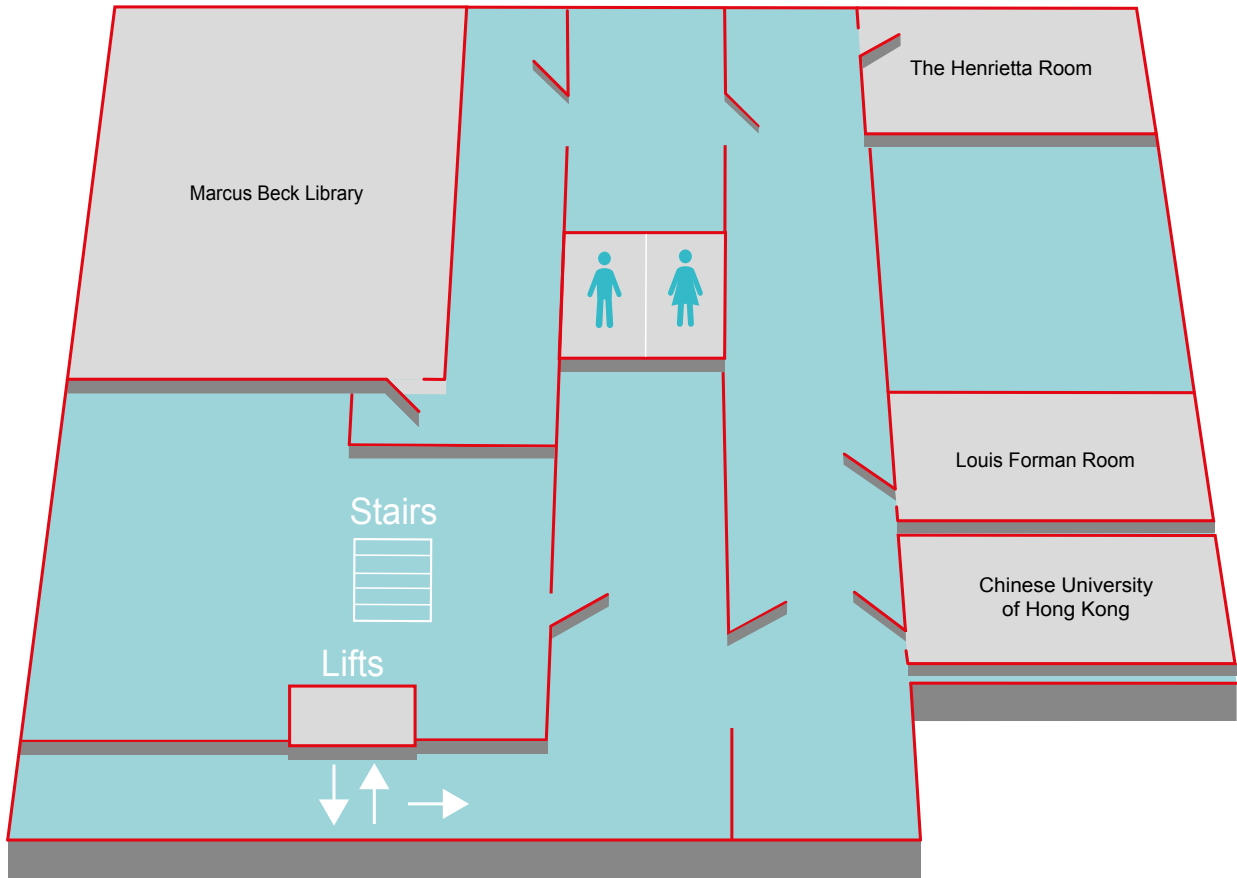

The Henrietta Room



Marcus Beck Library



Chinese University of Hong Kong



Louis Forman Room